

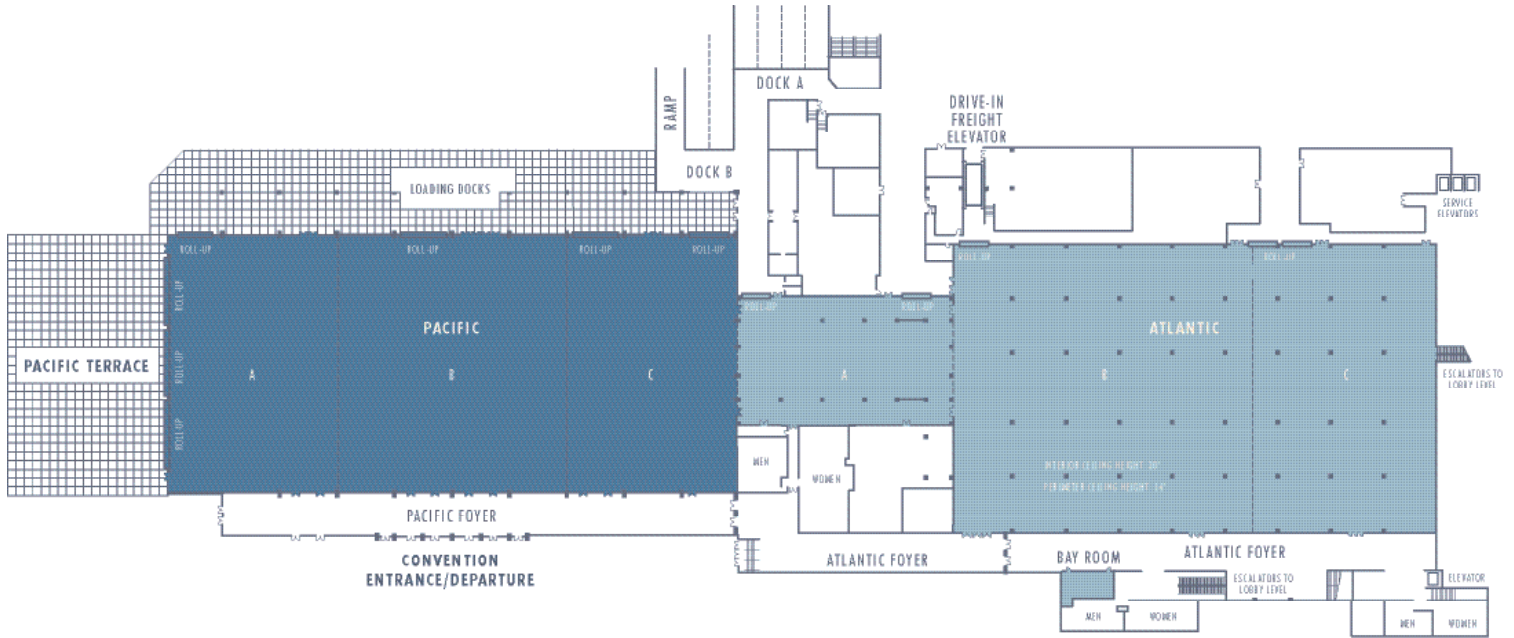

WALT DISNEY WORLD
DOLPHIN

Lower Level



MEETING ROOM	SQ. FT.	LENGTH	WIDTH	CEIL. HT.	LOW PT.	8' x 10'	10' x 10'	THEATRE	SCHOOL	CONF	BANQUET.	RECEPT
Atlantic/Pacific Halls	110,500	-	-	-	-	673	556	-	-	-	6,450	11,050
Pacific	49,920	320'	156'	25' 8"	23' 8"	332	255	6,100	3,595	-	3,360	4,492
Pacific A	14,976	156'	96'	25' 8"	23' 8"	98	78	1,800	1,040	-	1,020	2,000
Pacific B	19,968	156'	128'	25' 8"	23' 8"	122	117	2,200	1,348	-	1,410	3,500
Pacific C	14,976	320'	156'	25' 8"	23' 8"	85	78	1,800	1,016	-	1,020	2,000
Pacific Terrace	16,200	-	-	-	-	-	-	-	-	-	1,300	1,620
Atlantic	60,575	-	-	-	-	341	301	-	-	-	3,450	6,058
Atlantic A	9,300	124'	75'	12' 8"	12' 8"	28	28	660	405	-	580	1,570
Atlantic B	31,850	182'	175'	30'	14'	178	150	-	-	-	1,920	4,400
Atlantic C	19,425	175'	111'	30'	14'	111	95	-	-	-	1,120	2,800
Atlantic B/C	51,275	2,939	175'	30'	14'	313	263	-	-	2,920	2,920	7,200
Bay Room	465	31'	15'	12' 4"	12' 4"	-	-	41	24	22	24*	-

Numbers shown assume maximum capacities and are subject to change upon specific program requirements. Atlantic Hall Foyer is 11,977 sq ft with 1,198 reception capacity. Pacific Hall Foyer is 6,355 sq ft.



WALT DISNEY WORLD
DOLPHIN

Lobby Level

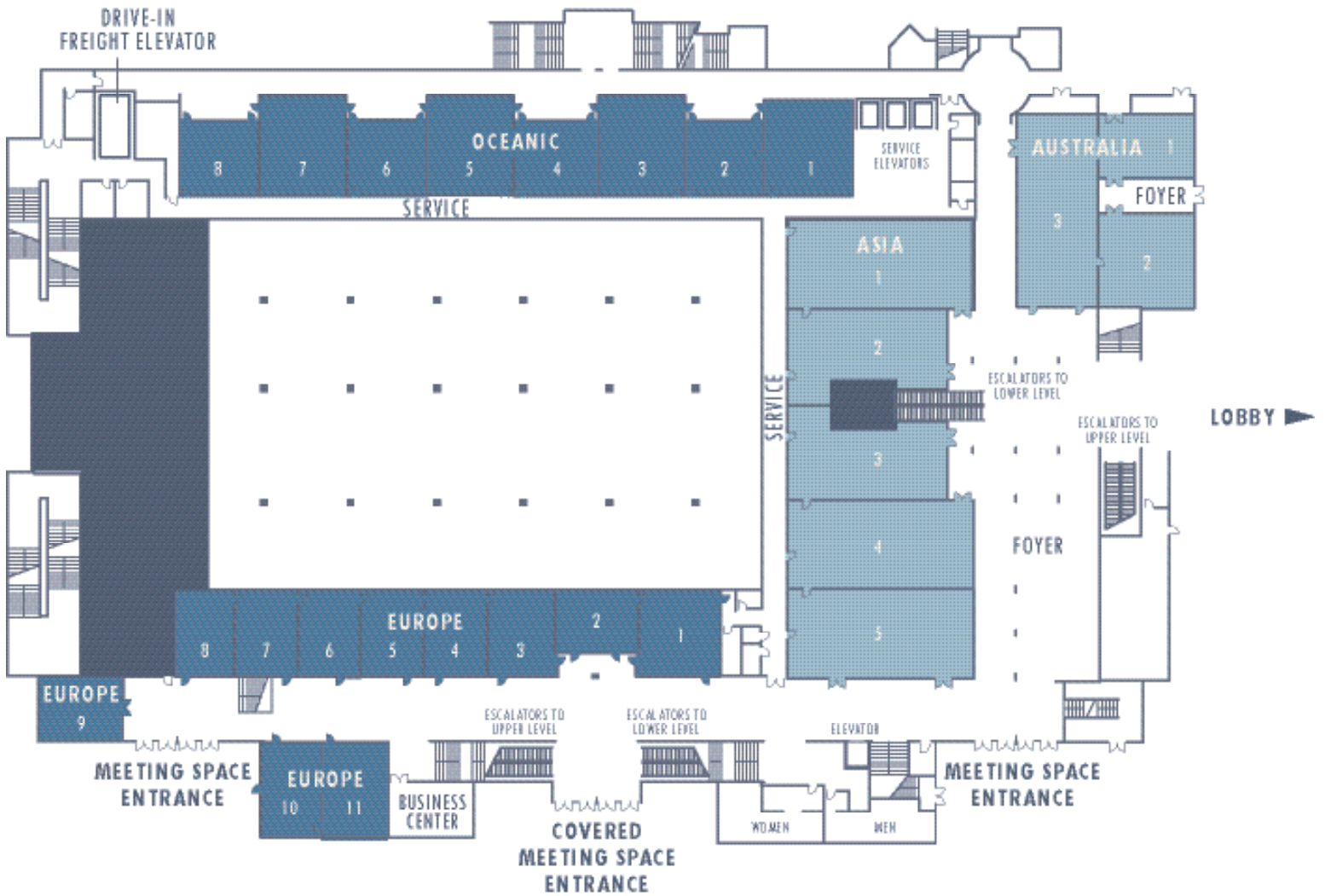

MEETING ROOM	SQ. FT.	LENGTH	WIDTH	CEIL. HT.	LOW PT.	THEATRE	SCHOOL	H/S	U-SHAPE	CONF	BANQUET	RECEPT.
Oceanic 1	1,122	37'	29'5"	11'9"	10'5"	104	70	42	33	30	70	160
Oceanic 2	772	29'	27'1"	11'9"	10'11"	78	44	30	27	24	50	100
Oceanic 3	1,130	36'10"	26'11"	11'9"	10'5"	104	74	42	33	30	70	160
Oceanic 4	849	29'9"	29'	11'9"	11'	84	48	36	27	24	50	100
Oceanic 5	1,105	35'10"	29'5"	11'9"	10'5"	104	74	42	33	30	70	160
Oceanic 6	845	29'7"	28'11"	11'10"	11'1"	84	48	36	27	24	50	100
Oceanic 7	1,115	36'11"	29'3"	11'9"	10'4"	104	74	42	33	30	70	160
Oceanic 8	848	29'9"	28'11"	11'9"	11'	84	48	36	27	24	50	100
Europe 1	869	30'4"	29'1"	11'8"	10'11"	70	48	36	27	24	50	100
Europe 2	806	31'7"	26'2"	11'5"	11'	64	44	36	27	24	50	100
Europe 3	740	30'4"	24'11"	11'8"	10'11"	72	40	36	27	24	50	75
Europe 4	703	31'7"	22'10"	11'7"	10'11"	60	48	36	30	24	50	75
Europe 5	736	32'8"	23'1"	11'8"	11'	66	45	36	30	24	50	75
Europe 6	700	29'11"	23'	11'9"	10'11"	60	42	36	30	24	50	75
Europe 7	690	31'1"	22'8"	11'9"	11'1"	66	42	36	30	24	50	75
Europe 8	706	32'9"	21'7"	11'10"	11'1"	65	45	30	30	24	50	75
Europe 9	644	30'10"	21'3"	11'9"	11'	68	43	30	24	24	50	75
Europe 10	732	33'5"	22'1"	11'8"	10'11"	65	45	30	30	24	50	75
Europe 11	751	32'6"	23'3"	11'8"	11'	65	45	30	30	42	50	75
Asia 1	2,241	70'9"	32'1"	11'5"	10'6"	239	160	72	63	60	160	300
Asia 2	1,772	59'10"	27'4"	11'8"	9'5"	169	104	60	51	48	110	260
Asia 3	1,769	59'10"	27'2"	11'9"	9'5"	162	104	60	51	48	110	260
Asia 4	2,259	70'6"	32'5"	11'5"	10'5"	228	159	72	63	54	160	300
Asia 5	2,282	70'7"	31'2"	11'5"	10'11"	222	141	72	63	60	130	300
Australia 1	696	33'9"	21'3"	11'5"	8'8"	-	-	-	-	16	-	-

Numbers shown assume maximum capacities and are subject to change upon specific program requirements.

* Boardroom features permanent table.



WALT DISNEY WORLD
DOLPHIN

Upper Level

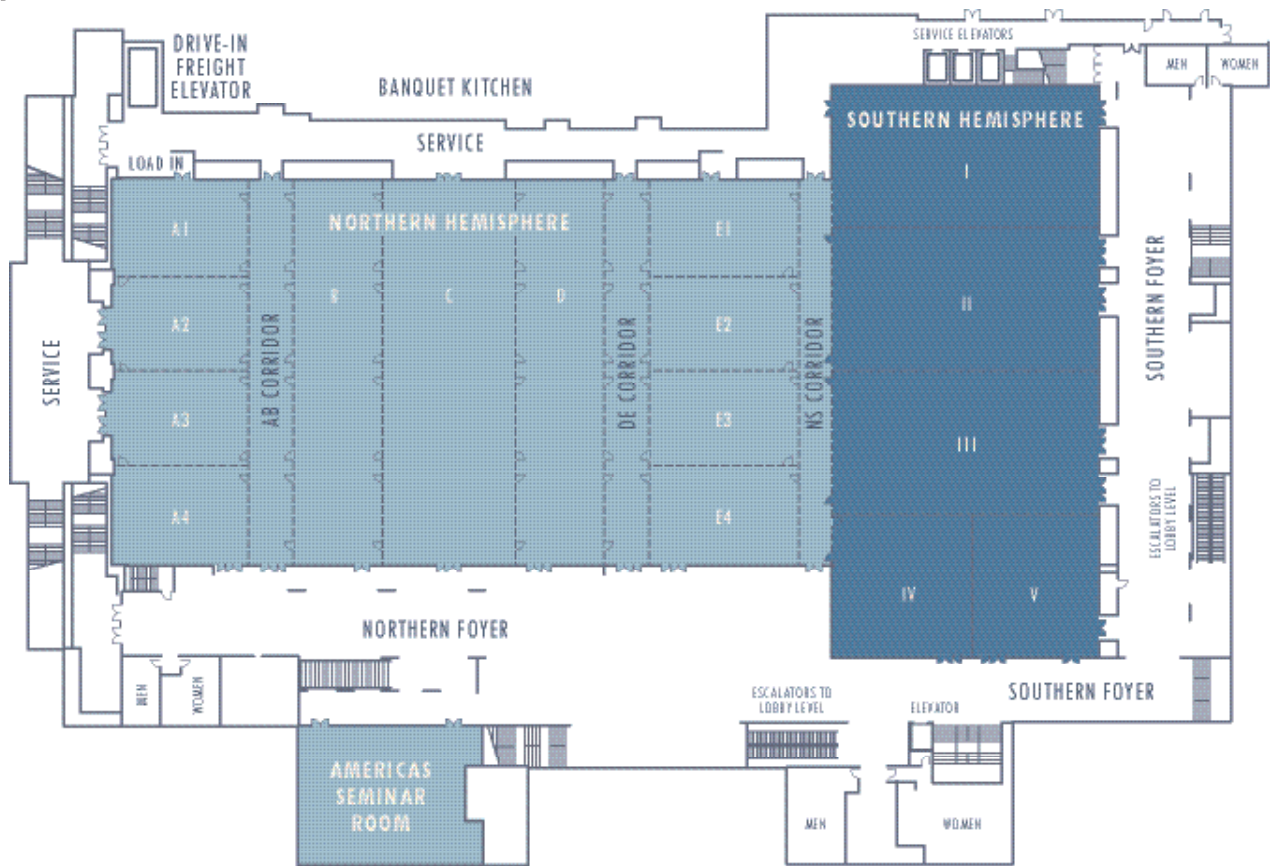

MEETING ROOM	SQ. FT.	LENGTH	WIDTH	CEIL. HT.	LOW PT.	THEATRE	SCHOOL	H/S	U-SHAPE	CONF	BANQUET	RECEPT.
Hemispheres Ballroom	54,238	351' 10"	199' 10"	27' 4"	22' 2"	6,020	3,645	-	-	-	3,540	5,424
Northern Hemisphere	33,556	244' 11"	137' 8"	27' 4"	22' 2"	3,725	2,736	-	-	-	2,310	3,356
A/B/C/D	26,256	137' 8"	71' 4"	22' 2"-27' 4"	22' 2"	1,494	892	-	-	-	900	2,210
B/C/D/E	24,276	137' 8"	73' 7"	22' 2"-27' 4"	27' 4"	-	-	-	-	-	-	-
Salon A	6,672	137' 8"	48' 2"	22' 2"	22' 2"	680	432	-	-	-	440	1,080
Salon A1	1,672	48' 2"	34' 8"	27' 4"	22' 2"	208	112	54	45	36	120	285
Salon A2	1,664	48' 2"	33' 8"	27' 4"	22' 2"	208	112	54	45	36	120	285
Salon A3	1,664	48' 2"	33' 8"	22' 2"	22' 2"	208	112	54	45	36	120	285
Salon A4	1,672	48' 2"	34' 8"	22' 2"	22' 2"	208	112	54	45	36	120	285
Salon B	4,343	137' 8"	31' 9"	27' 4"	27' 4"	-	-	-	-	-	-	-
A/B Corridor	2,191	137' 8"	15' 11"	27' 4"	22' 2"	-	-	-	-	-	-	-
Salon B + A/B Corridor	6,534	137' 8"	47' 8"	27' 4"	22' 2"	814	480	-	-	-	460	1,130
Salon C	6,493	137' 8"	47' 8"	27' 4"	27' 4"	814	460	-	-	-	460	1,130
Salon D	4,343	137' 8"	31' 8"	27' 4"	27' 4"	-	-	-	-	-	-	-
D/E Corridor	2,214	137' 8"	16' 1"	27' 4"	27' 4"	-	-	-	-	-	-	-
Salon D + D/E Corridor	6,557	137' 8"	47' 9"	27' 4"	27' 4"	814	460	-	-	-	460	1,130
Salon B/C/D	15,179	137' 8"	111' 7"	27' 4"	27' 4"	2,030	1,012	-	-	-	990	2,520
Salon B/C	10,836	137' 8"	79' 7"	27' 4"	27' 4"	1,482	800	-	-	-	660	1,650
Salon C/D	10,836	137' 8"	79' 6"	27' 4"	27' 4"	1,482	800	-	-	-	660	1,650
Salon E	7,296	137' 8"	53' 3"	22' 2"	22' 2"	844	472	-	-	-	480	1,280
Salon E1	1,841	53' 3"	34' 8"	22' 2"	22' 2"	210	126	60	51	42	120	285
Salon E2	1,841	53' 3"	34' 8"	22' 2"	22' 2"	210	126	60	51	42	120	285
Salon E3	1,841	53' 3"	34' 8"	22' 2"	22' 2"	210	126	60	51	42	120	285
Salon E4	1,841	53' 3"	34' 8"	22' 2"	22' 2"	210	126	60	51	42	120	285
N/S Corridor	1,801	137' 8"	13' 1"	22' 2"	22' 2"	-	-	-	-	-	-	-
Salon E + N/S Corridor	9,097	137' 8"	66' 4"	22' 2"	22' 2"	1,110	600	-	-	-	550	1,350
Northern Foyer	14,400	-	-	-	-	-	-	-	-	-	-	1,440
Southern Hemisphere	18,881	199'	92' 5"	22' 2"	22' 2"	2,096	909	-	-	-	1,200	1,888
Salon I	4,719	92' 5"	49' 3"	22' 2"	22' 2"	504	320	108	93	78	310	775
Salon II	4,793	92' 5"	51' 1"	22' 2"	22' 2"	528	320	108	93	78	320	775
Salon III	4,767	92' 5"	50' 8"	22' 2"	22' 2"	528	320	108	93	78	320	775
Salon IV	2,315	48' 11"	45' 8"	22' 2"	22' 2"	231	135	66	51	36	150	375
Salon V	2,287	48' 11"	45' 5"	22' 2"	22' 2"	220	135	66	51	36	150	375
Salon IV/V	4,602	92' 5"	48' 11"	22' 2"	22' 2"	480	300	108	93	78	310	775
Americas Seminar	2,822	63' 9"	45' 5"	11' 8"	10'	300	197	78	60	48	190	475
Southern Foyer	11,600	-	-	-	-	-	-	-	-	-	-	1,160

Numbers shown assume maximum capacities and are subject to change upon specific program requirements. N/S Corridor footage included in Hemispheres Ballroom information.



WALT DISNEY WORLD
DOLPHIN

Premier Suite - Level 12

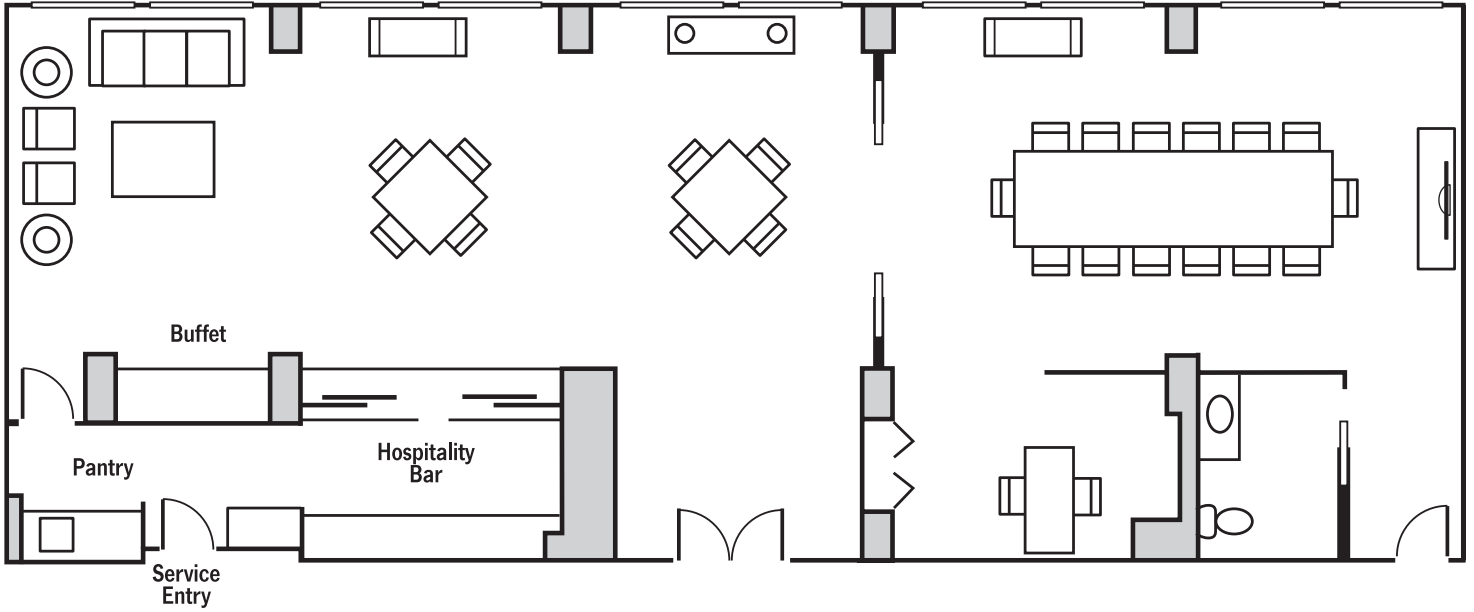

MEETING ROOM	SQ. FT.	LENGTH	WIDTH	CEIL. HT.	LOW PT.	CONF	RECEPT.
Premier Suite	1,102	66'	16'7"	8'	6'11"	14	65